

C420 Parts Guide

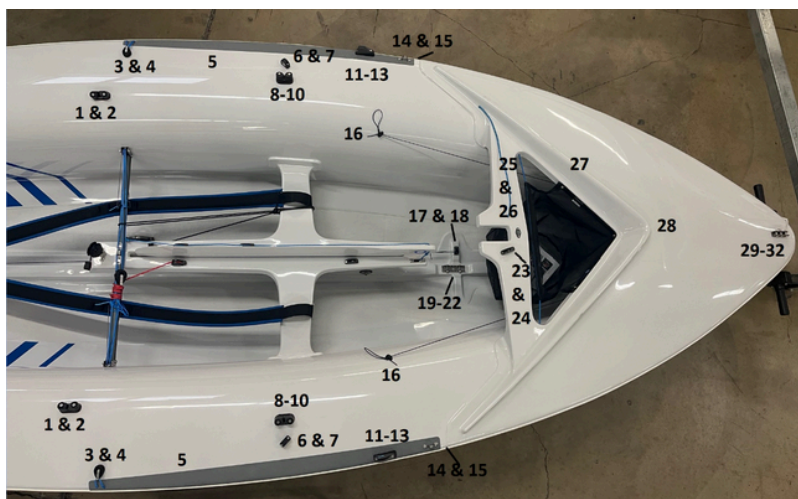

1. Spinnaker Camcleat H365 – 20039
2. Spinnaker Camcleat Screw (2) – Flat 10-32 x 1 3/4 in
3. Spinnaker 29mm Single Fixed Block H348 - 20040
4. Dyneema - 3mm, 18inches
5. C420 Non-Skid Set, Long (3in X 60in) - 20063
6. Jib Fairlead - 20005
7. Jib Fairlead Screw (2) – Pan 10-32 x 1 1/2 in
8. Jib Camcleat H365 - 20039
9. Jib Camcleat Wedge - 20038
10. Jib Cleat Screw (2) – 10-32 x 1 3/4 in
11. Spinnaker Guy Clamcleat - 20010
12. Spin Guy Clamcleat Wedge - 20011
13. Spin Guy Clamcleat Screw (2) – Flat 10-32 x 1 1/2 in
14. Shroud Eyestrapp, Forged - 20055
15. Shroud Eyestrapp Screw (2) – Pan 1/4-20 x 1 1/2 in
16. Ronstan Small Fairlead – 20006
- 16b. Fairlead Screw (2) – Pan 6-32 x 3/4 in
17. Ronstan Large Fairlead - 20005
18. Fairlead Screw – Pan 10-32 x 1 1/2 in
19. Mast Step – 20026
- 19b. Selden Mast Step (Not Pictured) - 44009
20. Mast Step Screw (3) – Flat 10-32 x 3/4 in
21. Mast Step Bolt (Not Pictured) (2) – Pan 1/4-20 x 1 1/4 in
22. Mast Step Nut (Not Pictured) - 1/4-20 Jam Nyloc
23. Mast Retainer Clam Cleat - 20042
24. Clam Cleat Screw



Deck Fittings

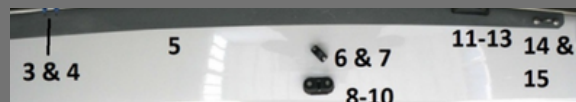

25. Through-Deck Bushing - 20012
26. Deck Bushing Screw (2) – Pan 6-32 x 3/4 in
- 26b. Deck Bushing Nut (2) – 6-32 Nyloc
27. Spinnaker Bag - 20300
28. (Below deck) Ronstan Small Fairlead – 20006
- 28b. Fairlead Screw – Pan 6-32 x 3/4 in
29. C420 Bow Chainplate - 20047
30. Clevis Pin, 1/4 in x 1 in - 20253
31. RWO Ring Ding - 20035
32. Chainplate screw (3) – Flat 1/4-20 x 3/4 in
- 32b. Chainplate Washer (3) – 1/4in x 5/8in
- 32c. Chainplate Nut (3) - 1/4-20 Nyloc
33. C420/FJ Back Up Bar, Small (Guy Cleat) - 20243
34. C420/FJ Back Up Bar, Large (Shroud Chain Plate) - 20242
- 35 & 36. Back-Up Bar Screw
37. Back-Up Bar Nut

Traveler Bar

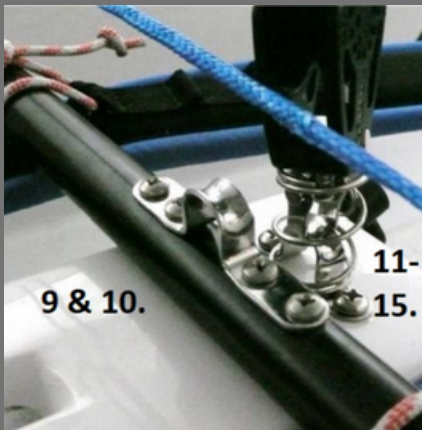
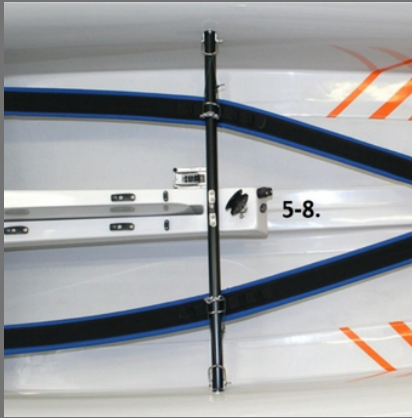

1. Traveler Bar, Complete - **20037**
2. Traveler Bar End Mount - **20434**
3. Traveler Bar End Mount Screw (2) - **Pan 10-32 x 3/4 in**
4. Bridle and Bar Mount Bolt - **1/4-20 x 1 3/8 in**
- 4b. Bridle and Bar Mount Nut – **1/4-20 Lock Nut**
- 4c. Bridle Bolt Bushing - **20074**
5. Spinnaker Halyard Cleat - **20046**
6. Spin Halyard Cleat Screw (2) - **Pan 8-32 x 1 1/4 in**
- 6b. Spin Halyard Cleat Washer (2) - **10 x 7/16**
- 6c. Spin Halyard Cleat Nut (2) - **8-32 nyloc**
7. Spin Halyard Bushing – **20012**
8. Spin Halyard Bushing Screw (2) – **Pan 6-32 x 3/4 in**
- 8b. Spin Halyard Bushing Washer (2) - **10 x 7/16**
- 8c. Spin Halyard Bushing Nut (2) - **6-32 Nyloc**
9. 4-Hole Eyestraps - **20044**
10. 4-Hole Eyestraps Screw (4) – **Pan 10-32 x 2in**
- 10b. 4-Hole Eyestraps Washer (4) - **10 x 7/16**
- 10c. 4-Hole Eyestraps Nut (2) - **10-32 Nyloc**
11. 2-Hole Eyestraps - **20034**
12. 2-Hole Eyestraps Screw (2) – **Pan 1/4-20 x 1in**
- 12b. 2-Hole Eyestraps Nut (2) - **10-32 Nyloc**
13. Stand-up Block Shackle - **20020**
14. Stand-up Spring - **20045**
15. 57mm Harken Mainsheet Block – **10015**



Centerboard Trunk

1. Harken Through-Deck Block - **20029**
2. Through-Deck Block Screw (2) – **3/16 x 1/2in**
- 2b. Through-Deck Block Washer - **10 x 7/16**
3. C420 Centerboard Pivot Bolt Assembly - **20271**
4. C420 Hiking Strap Plate - **20015**
5. Hiking Strap Plate Screw (2) – **Pan 10-32 x 3/4 in**
- 5b. Hiking Strap Plate Nut (2) - **10-32 Nyloc**
6. Clamcleat CL211MK2 – **20042**
 1. Clamcleat Screw (2) – **Flat 8-32 x 3/4 in**
- 7b. Clamcleat Washer (2) - **10 x 7/16**
- 7c. Clamcleat Nut (2) - **8-32 Nyloc**
8. Clamcleat Line Keeper – **20087**
9. Line keeper screw
10. C420 Hiking Strap - **20016**
11. Anderson Super Shute SS60 Bailer – **24007**
- 11b. Older Models: Super Mini Bailer - **20007**
- 11c. Other Builders: Super Medium Bailer - **20174**
12. C420 Vang Lead Block (20mm) – **20370**
13. Lead Block Screw
14. Centerboard – **20102 (white), 20207 (gray)**

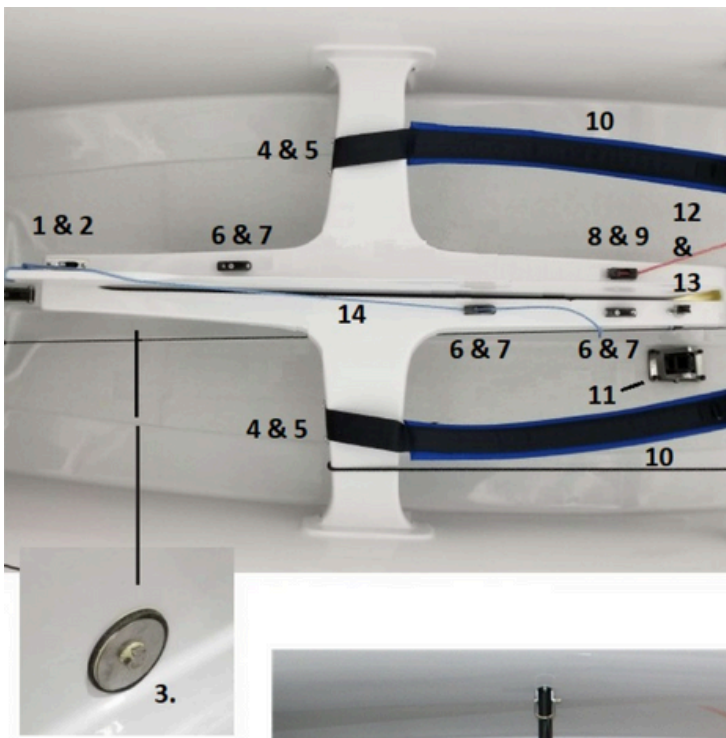

Centerboard Gasket

1. Gasket Retainer - **20018**
2. Polyester Gasket - **20210**
- 2b. Sailcloth Gasket - **20354**
3. Gasket Retainer Screws (22) – **Flat #8 x 3/4 in**



1. Upper Pintle - **20032**, LP Boats use **20270**
2. Upper Pintle Screws (2) – **1/4 -20 x 1 1/2 in**
- 2b. Upper Pintle Washer (2) - **1/4 x 5/8**
- 2c. Upper Pintle Nut (2) - **1/4-20 Nyloc**
3. Rudder Clip - **20297**
4. Rudder Clip Screws (2) – **Pan 10-32 x 5/8 in**
- 4b. Rudder Clip Washer (2) - **10 x 7/16**
- 4c. Rudder Clip Nut (2) - **10-32 Nyloc**
5. Lower Pintle - **20031**, LP Boats use **20269**
6. Lower Pintle Screws (2) – **Pan 1/4 -20 x 1 in**
- 6b. Lower Pintle Nut (2) - **1/4-20 Nyloc**
7. Drain Plug - **20098**
8. Drain Plug Screw (2) – **Pan #6 x 1/2 in**
9. Eyestraps - **20034**
- 9b. Eyestrapscrew (2) – **Pan 1/4 -20 x 1in**
10. Eyestrapsnut (2) - **10-32 Nyloc**



Stern & Transom

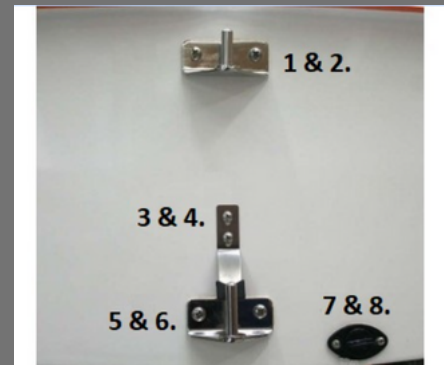

Rudder & Tiller

Rudder, Complete (White) - 20166

Rudder, Complete (Gray) - 20231

Rudder Head, Complete - 20075

1. Rudder Side Plate - 20072

2. Rudder Shim (Not Pictured) - 20124

3. Rudder Blade, White - 20076

3b. Rudder Blade, Gray (Not Pictured) - 20206

4. Rudder Pivot Bolt - 20169

5. Shockcord Hook (6mm) - 80200

6. Red Shock Block - 24101

7. Rudder Head Gudgeon - 20073

8. Gudgeon Bushing - 30004

9. Rudder Head Bolt - $\frac{1}{4}$ -20 x $\frac{3}{8}$ in

10. Rudder Head Lock Nut - $\frac{1}{4}$ -20

11. Rudder Spacer - 20074

12. Rudder Bushing - 30006

Tiller with Extension, 33in - 20344

Tiller with Extension, 36 in - 20121

13. Tiller Extension Only, 33in - 20077

14. Tiller Extension Only, 36in - 20097

15. Universal Tiller Joint - 20185

16. Tiller Joint Wedge - 80306

17. Aluminum Tiller Only - 20120

18. Micro Clam Cleat - 20109

19. Tiller Wedge - 80306

20. Tiller End Cap - 80307

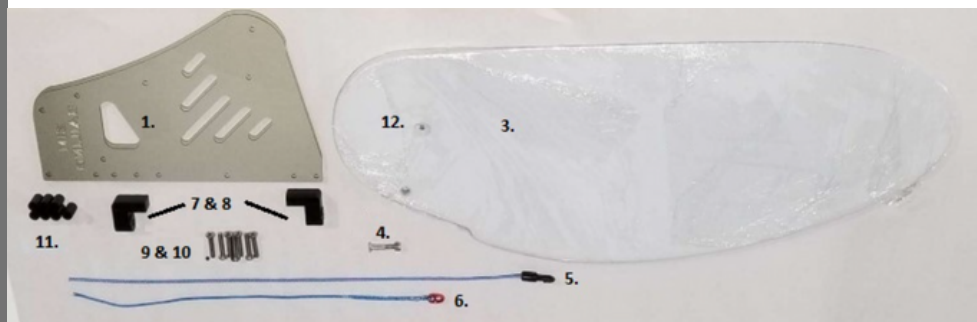

Dwyer Boom

Boom, Unrigged – 20004

Boom, Complete - 20114

1. Gooseneck Assembly - 20371
2. Outhaul Cheek Block 29mm – 20289
- 2b. Cheek Block Rivet
3. Mainsheet Boom Bail – 20215
- 3b. Mainsheet Boom Bail Rivet
4. Mainsheet Boom Block, 40mm 90° - 20115
5. Vang Bail – 20214
- 5b. Vang Bail Rivet
6. Small Clam Cleat, CL211MK2 - 20186
- 6b. Clam Cleat Rivet
7. Boom Eyestraps - 20218
- 7b. Eyestraps Rivet
8. 29mm Block - 20040
9. U Bracket - 20139
10. Split Ring - 20035
11. Universal Gooseneck - 20140
12. Gooseneck Clevis Pin - 20254
13. Gooseneck Bracket - 20265
14. Gooseneck Mast Rivet

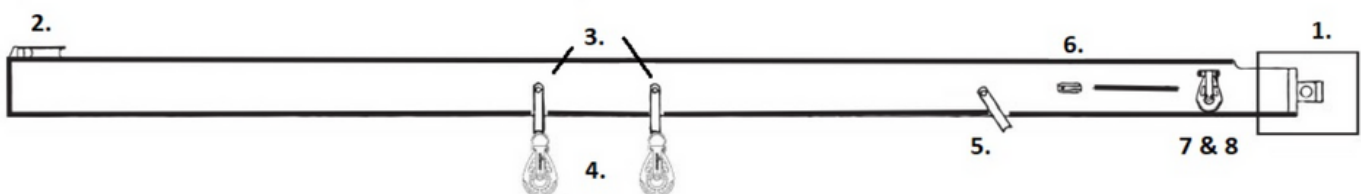
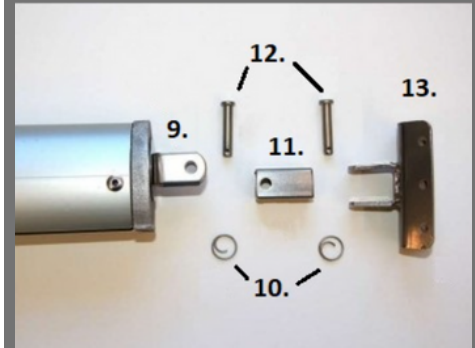

Selden Boom



Boom, Complete - 20318

1. Outhaul Cheek Block - 20219
2. Outhaul Eyestraps
- 2b. Outhaul Eyestraps Rivet (2)
3. Outhaul Cheek Block Screw
4. Mainsheet Block, 40mm - 43531
5. Selden Eyestraps (3) - 20442
- 5b. Eyestraps Screw (6)
6. Selden Eyestraps Clamp (6) - 20443
7. Outhaul Clam Cleat, CL211MK2 - 20186
8. Clam Cleat Screw
9. Outhaul Block, 30mm - 43553
10. Outhaul Block Eyestraps
11. Eyestraps Screw (2)
12. Gooseneck - 20250 or 20334
13. Spigot Assembly - 20438
14. Spigot - 20230
15. Spigot Pin - 20273

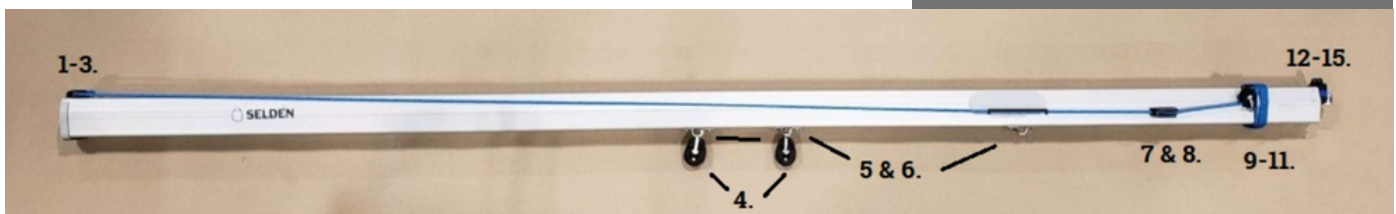

Mast



34-36

37 &
38

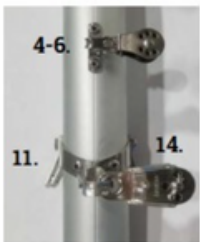

4-6.

11.

14.

7-14.

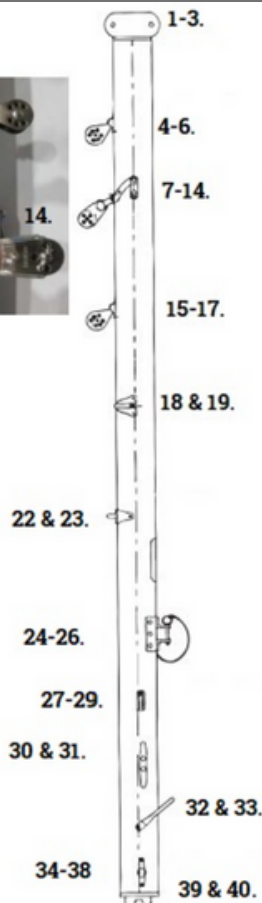

1. Masthead Casting – 20126
2. Masthead Sheave (2) – 20262
3. Masthead Clevis Pin (2) – 20253
4. Eyestraps – 20218
5. Eyestraps Screws (2)
6. Block, 22mm Limited Swivel – 20059
7. Hounds Assembly – 20128
8. Hounds Assembly Screw
9. Hounds Shackle – 20056
10. Hounds Bracket – 20257
11. Tang (2) – 20130
12. Hounds Assembly Bolt
13. Hounds Assembly Nut
14. Jib Halyard Wire Block – 20052
15. Block, 22mm Single Micro – 20041
16. Eyestraps
17. Eyestraps Screws (2)
18. Spreader Bracket – 20171
19. Spreader Bracket Screws
20. Spreaders (pair) – 20127 (Not Pictured)
21. Spreader Tips – 20319 (Not Pictured)
22. Spinnaker Pole Ring – 20220
23. Spinnaker Pole Ring Screw (2)
24. Gooseneck Bracket – 20265
25. Gooseneck Bracket Screw (6)
26. Gooseneck Pin
27. Short Nose Clam Cleat – 20186
28. Clam Cleat Screw
29. Eyestraps – 20218
30. Horn Cleat – 41004
31. Horn Cleat Screw (2)
32. Vang Bail – 20213
33. Vang Bail Screw (2)
34. Cheek Block, 22mm (2) – 20219
35. Cheek Block Screw
36. Standoff Spacer – 20221
37. Cheek Block, 29mm (Port) – 20289
38. Port Cheek Block Screw
39. Mast Base Casting – 20129
40. Mast Base Casting Rivet

Sails

1. Mainsail - **20083**
2. Jib sail - **20084**
3. Tell Tales - **20272**
4. Batten Set – **20274** (Not Pictured)
5. Top Batten - **20089**
6. Middle Batten - **20263**
7. Bottom Batten - **20264**

Our spinnaker stock varies, please call or email for current or custom colors available.



Spinnaker Poles



1. Tapered Spinnaker Pole – **20085** (Not pictured)
2. Tapered Spin Pole End - **20183**
3. Non-Tapered Spin Pole - **20122**
4. Non-Tapered Spin Pole End - **20088**
5. Spin Pole Eyestraps (both) - **20118**
6. Eyestraps Rivet (2)



Rigging

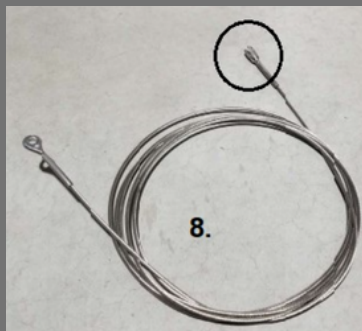

1. Shroud Wire - **20057**
2. Shroud Adjuster - **20208**
3. Shroud Fast Pin – **20068** OR
- 3b. Shroud Clevis Pin - **23054**
4. Roller Pin for Spin Guy - **20182**
5. Shroud Adjuster Cover - **20094**
6. Shroud Adjuster Cover, Long - **23081**
7. Forestay Wire – **20058**
8. **Link Plate Style Shroud** – 20111
9. Shroud Link Plate – **23057**
10. Z-Force Vang, Complete – 20229
11. Z-Force D Shackle – **20392**
12. Z-Force Shock Block, Small – **24101**
13. Z-Force Stopper Ball – **24103**
14. SCV 4:1 Vang, Complete – **20292**
15. SCV 4:1 Selden Vang – 20464
16. SCV 22mm Fiddle Block w/ Jam – **20149**
17. SCV 5mm Twist Shackle - **20267**
18. SCV 22mm Becket Block – **20070**
19. SCV 5mm D Shackle – **20392**
20. 16:1 Vang, Complete – **20110**
21. 16:1 Vang 22mm Micro Block (4) – **20041**
22. 16:1 Vang 22mm Becket Block – **20070**
23. 16:1 Vang 5mm Shackle (2) – **20071**

Not pictured:

1. Jib Halyard, Complete -**20061**
2. Jib Halyard Shackle - **20030**
3. Main Halyard Ring – **20106**
4. Main Halyard Stopper Ball – **20054**
5. Topping Lift Hook – **20060**
6. Bridle – **20105** or **20280**
7. Bridle Block, 29mm Single – **20040**

Trapeze

1. Trapeze, Complete - **20062**
2. Trapeze Ring w/ Block - **20066**
3. Trapeze Ring w/o Block - **20099**
4. Trapeze Clam Cleat - **20065**
5. Trapeze Donut Handle - **20064**
6. Trapeze Wire - **20390**
7. Trap Wire Shackle - **20020**

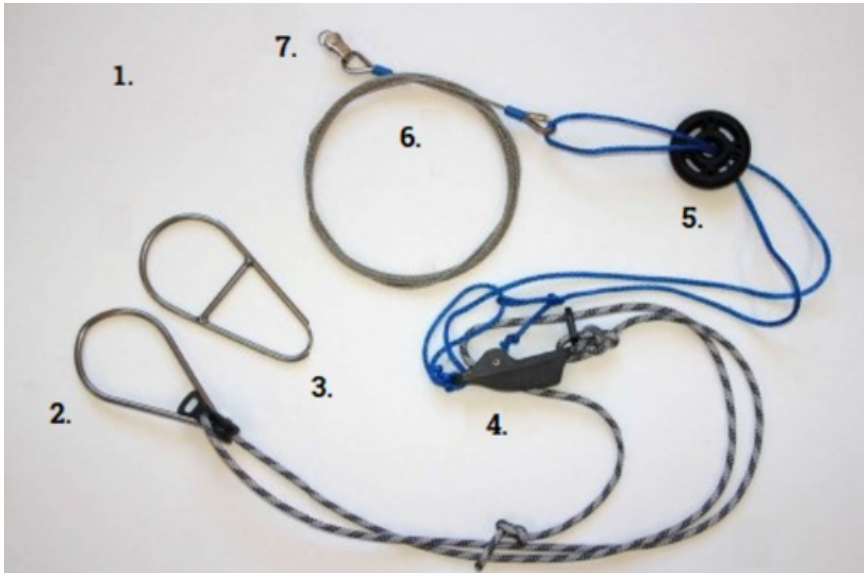

Accessories

24. Dynamic Dolly - **20400/20401**
25. Blade Bag - **20209**
26. Hull Cover - **20093**
27. Deck Cover - **20383**
28. Mainsail Bag - **20279**
29. Spinnaker Storage Bag - **20211**
30. C420 Line Kit - **20116**